

Certification	Case Material	Protection class
CE RoHS	Aluminum	IP20

Heater for electrical cabinet wet applications in need of protection, or the temperature is not below a specified minimum number of occasions. Aluminum profile body design more stable form of the chimney effect of the release of heat. Pressure terminal connectors save time and be more simpler to install.

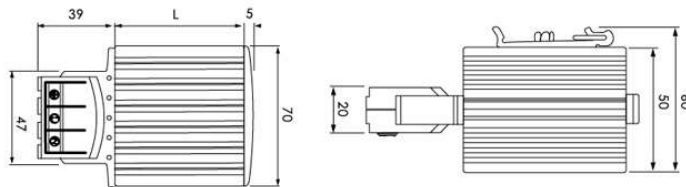

Dimensions



Voltage end of the 140V will be reduced by about 10% of the heat output

Model	Order	Heat output (W) 20 °C ambient temperature	Maximum Allowable Current (A)	L(mm)	Weight (kg)
JRQ15	2020.001	15	1.5	65	0.2
JRQ30	2020.002	30	3	65	0.2
JRQ45	2020.003	45	3.5	65	0.2
JRQ60	2020.004	60	2.5	140	0.36
JRQ75	2020.005	75	4	140	0.36
JRQ100	2020.006	100	4.5	140	0.36
JRQ150	2020.007	150	9	220	0.54

Technical data

Operating Voltage	230VAC 50/60 Hz
Heating element	PTC, self-adjustment and temperature limits
Electrical connection	3 pressure line terminal, the standard line of 0.5-2.5mm <sup>2</sup>
Connection terminal	UL94V <sub>0</sub>
Installation Requirements	Vertical
Operating / storage temperature	-45°C to +70°C